



HANIL

SINCE 1972

HEAT TRANSFER & EQUIPMENT

NOVEMBER 2016

HANIL HEAVY INDUSTRIES CO., LTD.

<http://www.hanilhi.com>



- *1. Company Profile*
- *2. Product Group*
- *3. Company Organization*
- *4. Manufacturing Facilities*
- *5. Recent Reference Photos*
- *6. Major Reference & Clients List*
- *7. Certificates*
- *8. Progress Management Program*

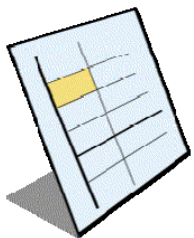



- *1. Company Profile*
- *2. Product Group*
- *3. Company Organization*
- *4. Manufacturing Facilities*
- *5. Recent Reference Photos*
- *6. Major Reference & Clients List*
- *7. Certificates*
- *8. Progress Management Program*

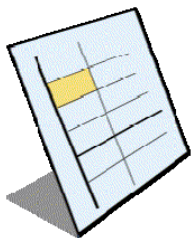

1. Company Profile



HANIL

NAME OF COMPANY : HANIL HEAVY INDUSTRIES CO., LTD.

ESTABLISHED : MARCH 1972

PRESIDENT : MR. JEUNG-WON PARK

HEAD OFFICE & FACTORY : 33, SINHANG 7-RO, JINHAE-GU , CHANGWON-SI, GYEONGSANGNAM-DO, 51619, SOUTH KOREA

SEOUL OFFICE : 8TH FLOOR, CHEONGJIN BLDG., 17, HYORYEONG-RO, SEOCHO-GU, SEOUL 06694, SOUTH KOREA

MAN POWERS : 105

BUSAN FACTORY : 94

SEOUL OFFICE : 10

UAE OFFICE : 1



HANIL HEAVY INDUSTRIES CO., LTD.



- *1. Company Profile*
- *2. Product Group*
- *3. Company Organization*
- *4. Manufacturing Facilities*
- *5. Recent Reference Photos*
- *6. Major Reference & Clients List*
- *7. Certificates*
- *8. Progress Management Program*

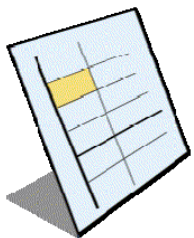



Industrial & Power Boilers

Fired Heaters & SRU Equipment

Special Material Heat Exchangers



- *1. Company Profile*
- *2. Product Group*
- *3. Company Organization*
- *4. Manufacturing Facilities*
- *5. Recent Reference Photos*
- *6. Major Reference & Clients List*
- *7. Certificates*
- *8. Progress Management Program*

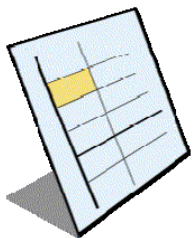

3. COMPANY ORGANIZATION



HANIL

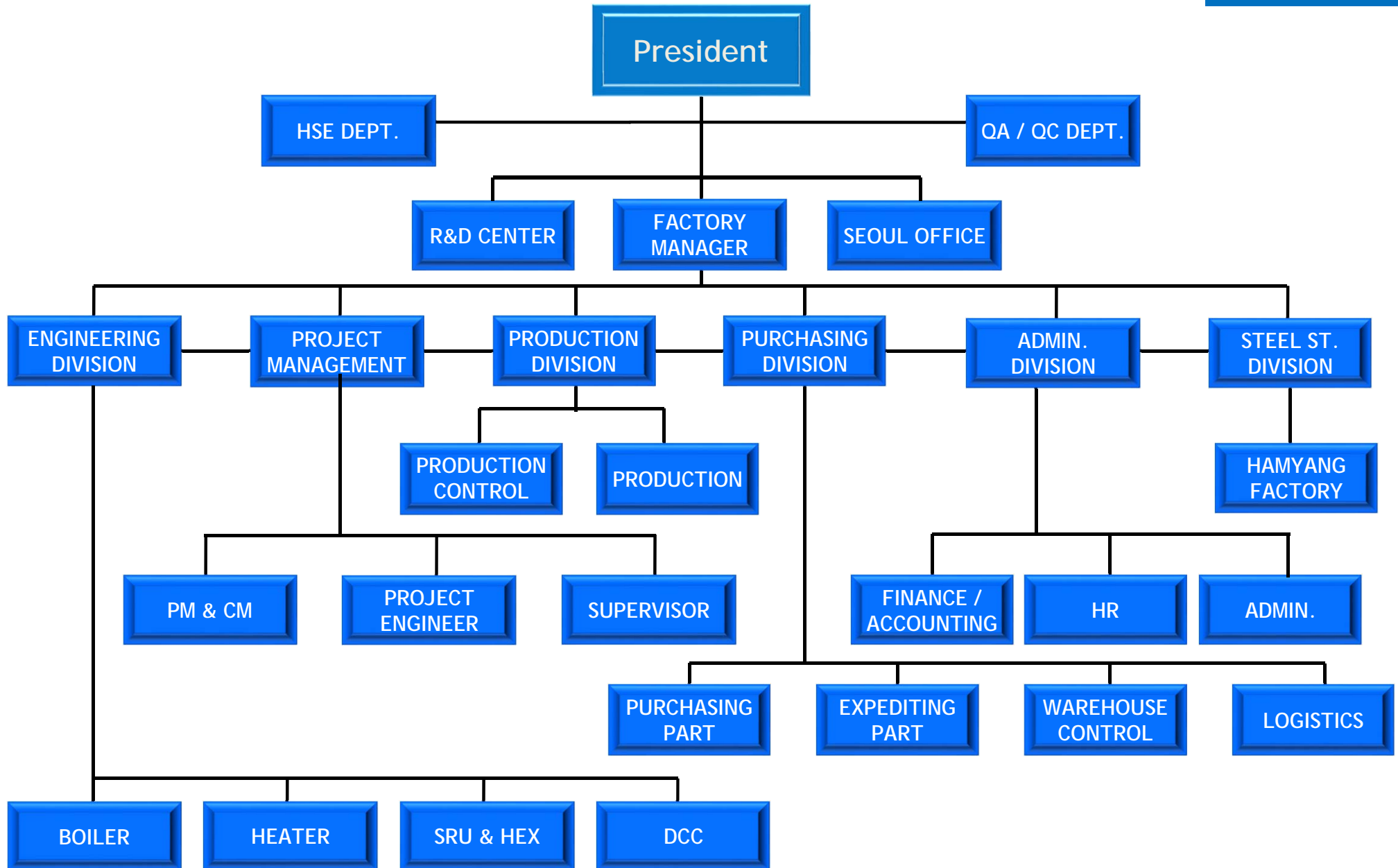



- *1. Company Profile*
- *2. Product Group*
- *3. Company Organization*
- *4. Manufacturing Facilities*
- *5. Recent Reference Photos*
- *6. Major Reference & Clients List*
- *7. Certificates*
- *8. Progress Management Program*

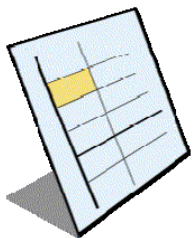



HEAD OFFICE & FACTORY



TOTAL AREA : 36,750 M2 / SHOP AREA : 16,528 M2
[PRODUCTION CAPACITY : 30,000 TONS / YEAR]



HEAD OFFICE & FACTORY

- #1 OFFICE BUILDING: 4F
- #2 MAIN WORKSHOP: 10,800M2 (3,300 PY) - 25mW x 144mL x 4 BAYS
- #3 SHOT BLASTING SHOP: 1,461M2(442 PY)
- #4 PAINTING SHOP (MOVING SHELTER): 8,086M2(2,446 PY)
- #5 MACHINING LINE FOR SECTION STEEL:
CNC DRILLING, CUTTING, BEVELLING

- #6 PRE ASSEMBLY AREA
- #7 MATERIAL STORAGE AREA
- #8 OFFICE FOR PRODUCTION
CONTROL & PART STORAGE
- #9 PACKING & STORAGE AREA





FACTORY LAYOUT

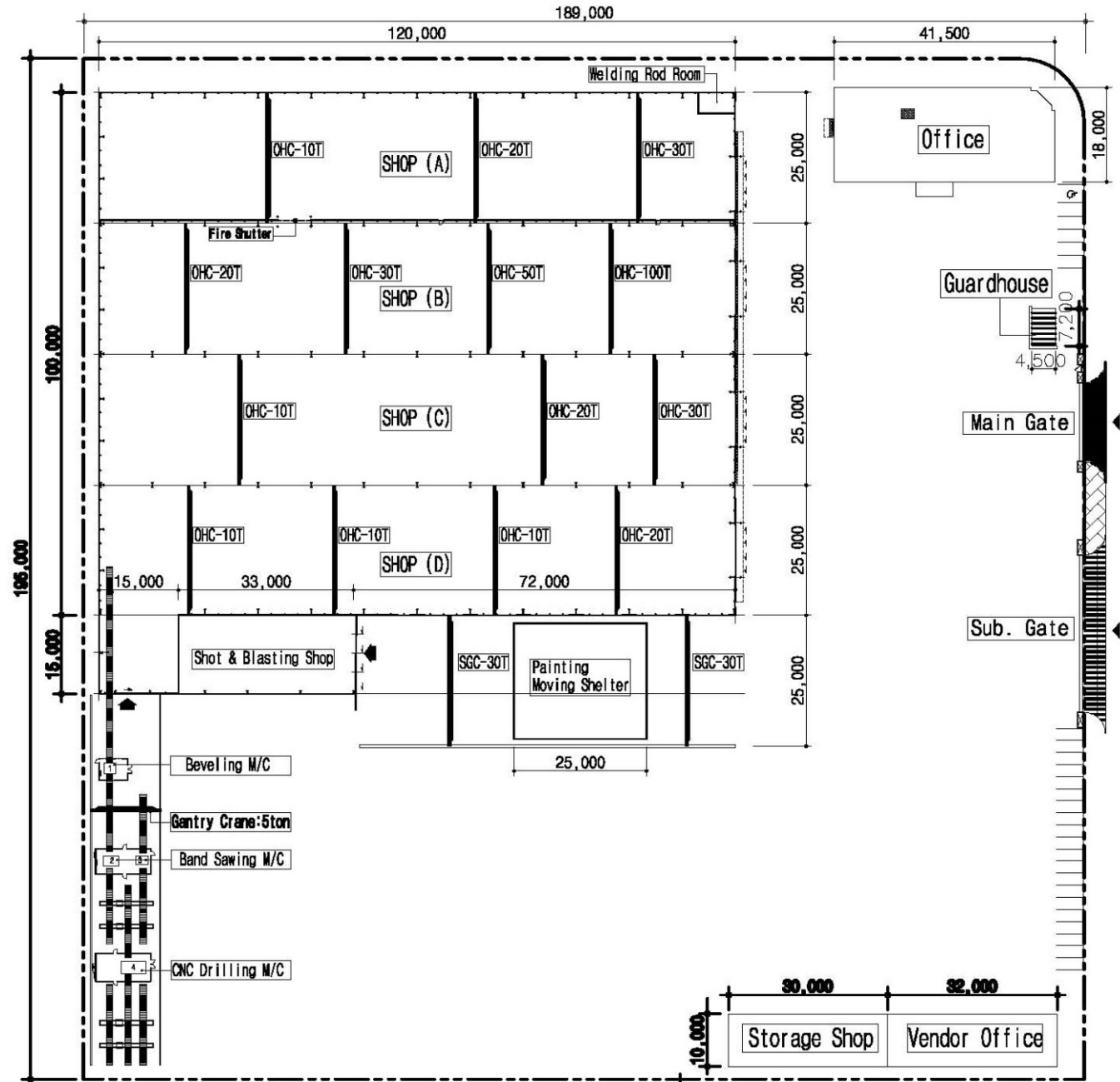



LOCATION AT BUSAN NEW PORT – GEOGRAPHICAL ADVANTAGE (Direct Port Access & Loading onto Vessel)





- *1. Company Profile*
- *2. Product Group*
- *3. Company Organization*
- *4. Manufacturing Facilities*
- *5. Recent Reference Photos*
- *6. Major Reference & Clients List*
- *7. Certificates*
- *8. Progress Management Program*

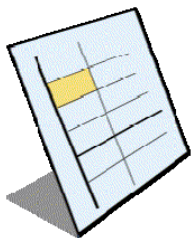



Boiler Package

MAXIMUM CAPACITY

- WATER TUBE BOILER : 250T/H x 150 BAR.G
- SMOKE TUBE BOILER : 30T/H x 40 BAR.G
- WASTE HEAT BOILER : 400T/H x 150 BAR.G



HP STEAM BOILER - LAVAN OIL REFINERY, IRAN



WATER TUBE BOILER -
GASCO HSGP PROJECT, U.A.E.



ICW WASTE HEAT BOILER -
SAMSUNG ELECTRONICS CO., S. KOREA



Boiler Package



STEAM DRUM OF WHB -
PARDIS 3RD UREA & AMMONIA, IRAN



SMOKE TUBE BOILER - HYFLUX LTD, SIEMENS /
TUASPRING, SINGAPORE



WASTE HEAT BOILER -
PARDIS 3RD UREA & AMMONIA, IRAN



AUXILIARY BOILER -
PARDIS 3RD UREA & AMMONIA, IRAN



Fired Heaters

MAXIMUM CAPACITY

- CYLINDRICAL : 200 T/UNIT x 50 UNITS/YEAR
- BOX : 1,000 T/UNIT x 10 UNITS/YEAR



PGSOC/BANDAR ABBAS GAS CONDENSATE REFINERY PROJECT, IRAN



YPFBR S.A., TECNICAS REUNIDAS / SANTA CRUZ & COCHABAMBA PROJECT, BOLIVIA



NIORDC, IGC/LAVAN OIL REFINERY, IRAN



SRU Equipment

MAXIMUM CAPACITY

- THERMAL REACTOR : 150 T/UNIT x 20 UNITS/YEAR
- INCINERATOR : 250 T/UNIT x 20 UNITS/YEAR
- WASTE HEAT BOILER : 200 T/UNIT x 20 UNIT/YEAR
- CONDENSERS : 150 T/UNIT x 30 UNIT/YEAR
- PROCESS REACTORS : 100 T/UNIT x 40 UNIT/YEAR



THERMAL REACTOR - IRPC, SKEC /
UHV PROJECT, THAILAND



THERMAL REACTORS W/WHB -
JGC/SOHAR REFINERY, OMAN



THERMAL INCINERATORS W/WHB -
JGC/SOHAR REFINERY, OMAN



SRU Equipment



**THERMAL REACTOR -
GS CALTEX NO.4 DIESEL, S. KOREA**



**THERMAL INCINERATORS -
SPP12 POGC/TECNIMONT, IRAN**



**WASTE HEAT BOILER
- POGC, PPI / SOUTH PARS P.19**



STEAM DRUM - POGC, PPI / SOUTH PARS P.19



Special Material Heat Exchanger

MAXIMUM CAPACITY

- Φ 7,000 MM x 25M (L)



HASTELLOY HEAT EXCHANGERS ON PLATFORM
- POGC, IGC / SP P1 REVAMPING, IRAN
(TUBE-TO-TUBESHEET BY INTERNAL BORE WELDING)



TUBE BUNDLES OF TITANIUM HEAT EXCHANGER
- PGSOC / BANDAR ABBAS G&C PROJECT, IRAN

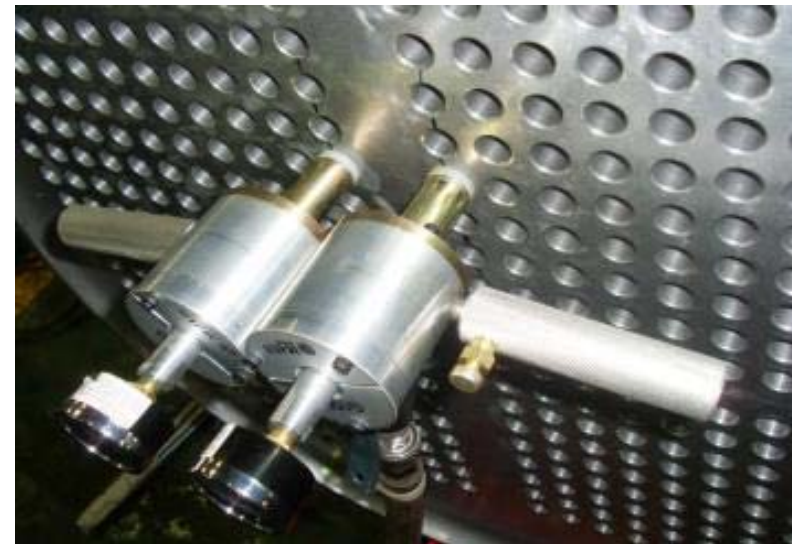

INCONEL HEAT EXCHANGER DURING HELIUM LEAK TEST - POGC, IGC / SP P1 REVAMPING, IRAN



Pressure Vessels

MAXIMUM CAPACITY

- Φ 8,000 MM X 120M (L)



BENZEN STRIPPER PACKAGE - INTECSA
SABIC SK WWT PROJECT IN SAUDI ARABIA



DEMETHANIZER - SECL
MOC PROJECT IN THAILAND



GS CALTEX TOWER - GS CALTEX
NO.3 HOU PROJECT, S. KOREA





Steel Works - Production Capacity : 70,000 Tons / Year



GS E&C / SALALAH METHANOL IN OMAN - 7,933 TONS



SECL / PTR PROJECT IN TRINIDAD & TOBAGO



LOTTE-SECL / LPG-SEG IN KOREA





- *1. Company Profile*
- *2. Product Group*
- *3. Company Organization*
- *4. Manufacturing Facilities*
- *5. Recent Reference Photos*
- *6. Major Reference & Clients List*
- *7. Certificates*
- *8. Progress Management Program*

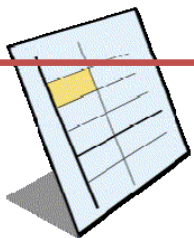

6. Major Reference List



HANIL

A. BOILERS (RECENT 10 YEARS)

CUSTOMER/PROJECT	SITE	ITEM NAME	CAPACITY - Q'TY	DEL.
SPE, SAMSUNG C&T / ALGERIA MOSTAGANEM CAPP PROJECT	ALGERIA	AUXILIARY BOILER (WT)	9 TPH x 12 BAR.G - 2	2017.03
SPE, SAMSUNG C&T / ALGERIA NAAMA CAPP PROJECT	ALGERIA	AUXILIARY BOILER (WT)	20 TPH x 12 BAR.G - 2	2016.11
HENGAM, PIDEC / HENGAM FERTILIZER PROJECT	IRAN	WASTE HEAT BOILER (ST) STEAM DRUM	332 & 56 & 107 TPH x 130 BAR.G - 3 495 TPH x 130 BAR.G - 1	2016.08
BUSHEHR PETROCHEMICAL / BUSHEHR METHANOL PLANT PROJECT	IRAN	WASTE HEAT BOILER (ST)	454 TPH x 124 BAR.G - 1	2016.07
CHEVRON, TSKE / CARBOXYLATE PROJECT	SINGAPORE	WASTE HEAT BOILER (WT)	5.3 TPH x 13 KG/CM2 - 1	2016.02
IRPC, JOHN ZINK / SKEC UHV PROJECT	THAILAND	WHB FOR THERMAL REACTOR (ST) WHB FOR THERMAL INCINERATOR (WT)	12 TPH x 52 BAR.G - 3 15 TPH x 52 BAR.G - 1	2015.04
GNS, MHI / GULF U-THAI CAPP PROJECT	THAILAND	AUXILIARY BOILER (ST)	6 TPH x 8 BAR.G - 1	2014.02
DAELIM / ULSAN COMBINED CYCLE POWER PLANT	S. KOREA	AUXILIARY BOILER (WT)	45 TPH x 37 BAR.G - 1	2014.02
PGSOC, NARDIS / BAGCR PROJECT	IRAN	WHB FOR THERMAL INCINERATOR (WT)	8.8 TPH x 51 BAR.G - 1	2013.12
DAEWOO E&C / ZWITINA POWER PLANT EXTENSION	LIBYA	AUXILIARY BOILER (WT)	20 TPH x 9 BAR.G - 1	2013.11
PPC, NDEC / PARDIS 3 RD UREA & AMMONIA	IRAN	WASTE HEAT (ST) & AUXILIARY BOILER (WT)	353 TPH x 125 BAR.G - 1 150 TPH x 46 BAR.G - 2	2013.09
SECL / INCINERATOR REVAMPING PROJECT	S. KOREA	WASTE HEAT BOILER (WT)	22.52 TPH x 25 KG/CM2 - 1	2013.07
HYFLUX LTD, SIEMENS / TUASPRING SINGAPORE	SINGAPORE	AUXILIARY BOILER (ST)	12 TPH x 10 BAR.G - 1	2013.06
DAELIM / POCHHEON LNG POWER PLANT	S. KOREA	AUXILIARY BOILER (WT)	26 TPH x 15 BAR.G - 1	2013.03
GNS, MHI / THAI GULF NONG SAENG PJT	THAILAND	AUXILIARY BOILER (ST)	6 TPH x 8 BAR.G - 1	2013.02
POGC, PPI / SOUTH PARS P19	IRAN	WHB FOR THERMAL INCINERATOR (ST)	38.7 TPH x 55 BAR.G - 2	2012.09
NEXEN, YOUJEONG / GIMHAE PLANT UPGRADING	S. KOREA	WATER TUBE BOILER	8 TPH x 16 KG/CM2 - 1	2012.07
GASCO, DODSAL / HSGP PROJECT NO. 5267	U.A.E	AUXILIARY BOILER (WT)	15 TPH x 10 BAR.G - 3	2012.04
SAMSUNG ENG. / NORTE II CCGT POWER	MEXICO	AUXILIARY BOILER (WT)	8 TPH x 10 BAR.G - 1	2012.02
POGC / SOUTH PARS PHASE 4 & 5	IRAN	AUXILIARY BOILER (ST)	17 TPH x 10 BAR.G - 2	2011.11
SAMSUNG ENGINEERING / RHINO	S. KOREA	WATER TUBE BOILER	30 TPH x 10 BAR.G - 1	2010.10
NIOEC, EHSAN JV / TEHRAN REFINERY UPGRADING	IRAN	WHB FOR THERMAL INCINERATOR (ST)	11 TPH X 55 BAR.G - 1	2010.04
LORC, IGC / LAVAN OIL REFINERY	IRAN	WATER TUBE BOILER	80 TPH x 51 BAR.G - 4	2010.02
DAEWOO E&C / MISURATA CAPP	LIBYA	AUXILIARY BOILER (WT)	20 TPH x 17 BAR.G - 1	2009.06
SAMSUNG ENGINEERING / SCP FALCON	S. KOREA	WATER TUBE BOILER	30 TPH x 10 KG/CM2 - 2	2008.01
TPPI / TUBAN AROMATIC PROJECT	INDONESIA	WATER TUBE BOILER	90 TPH x 52.8 KG/CM2 - 1	2007.09
QAPCO, ZEECO / EP2 PROJECT	QATAR	WASTE HEAT BOILER (ST)	103 TPH x 24.5 KG/CM2 - 3	2007.01
SAMSUNG ENGINEERING / SCP FALCON & RINO	S. KOREA	WATER TUBE BOILER	40 / 30 TPH x 10 KG/CM2 - 1 (EACH)	2006.02 / 11
DOOSAN HEAVY IND., SIMENS / PALOS	SPAIN	AUXILIARY BOILER (ST)	12 TPH x 12 KG/CM2 - 1	2003.12
JGC, HCE / SOHAR REFINERY	OMAN	WASTE HEAT BOILER (ST)	50 TPH x 20 KG/CM2 - 1	2003.08
SAMSUNG ENGINEERING / SEC HDI - 3 EXPANSION	S. KOREA	WATER TUBE BOILER	20 TPH x 10 KG/CM2 - 1	2003.07
DOOSAN, SIMENS / GEZER #3 & HAGIT #4	ISRAEL	AUXILIARY BOILER (ST)	11 TPH x 12 KG/CM2 - 3	2003.07





B. FIRED HEATERS (RECENT 10 YEARS)

CUSTOMER/PROJECT	SITE	ITEM NAME	CAPACITY - Q'TY	DEL.	REMARKS
YPFBR S.A., TECNICAS REUNIDAS-INITEC / ISOMERIZACIÓN (NUIS) SANTA CRUZ	BOLIVIA	FIRED HEATER	13.86 MW - 2	2015.05	
YPFBR S.A., TECNICAS REUNIDAS-INITEC / REFORMACIÓN (NURC) COCHABAMBA	BOLIVIA	FIRED HEATER	8.4 MW - 5	2015.03	
PPC, NDEC / PARDIS 3 RD UREA & AMMONIA	IRAN	START UP HEATER	13.8 MW - 1	2013.03	
PGSOC / BANDAR ABBAS GAS CONDENSATE REFINERY	IRAN	FIRED HEATER	142.56 GCAL/HR - 30	2012.03	
POGC, IPMI / SOUTH PARS 14	IRAN	FIRED HEATER	7.06 MW - 6	2012.02	
ILC, FARAB / IRAN LNG	IRAN	FIRED HEATER	8.6 MW - 4	2010.10	
LORC, IGC / LAVAN OIL REFINERY UP GRADING & REVAMPING	IRAN	FIRED HEATER	5.17 GCAL/HR - 7	2010.01	
HEC, RARCO / RARCO DHDS PLANT	PAKISTAN	FIRED HEATER	39.06 GCAL/HR - 1	2009.06	BY COLL.
NCP, DIC / NCP HOT OIL PLANT PROJECT	SAUDI ARABIA	FIRED HEATER	4.3 GCAL/HR - 1	2009.05	BY COLL.
RRC, SKEC / RRC UPGRADING & REVAMPING PROJECT	THAILAND	FIRED HEATER	9.28 GCAL/HR - 1	2008.12	BY COLL.
FWEL / BANGCHACK REFINERY PROJECT	THAILAND	REFORMER	500 TON - 1	2008.02	FAB.(J/V)
SKEC, KTI / KPPC AROMATIC COMPLEX PROJECT	KUWAIT	INTER HEATER	1,800 TON - 1	2007.04	FAB.(J/V)
GASCO, SNAMPROGETTI, ITT / RUWAIS 3 RD NGL TRAIN	UAE	REGENERATION GAS HEATER	135 TON - 1	2006.09	FAB.(J/V)
MHI, ITT / SOHAR REFINERY PROJECT	OMAN	START UP HEATER	135 TON - 1	2006.02	FAB.(J/V)
GS E&C / SOUTH PARS FIELD 9 & 10	IRAN	FIRED HEATER	450 TON - 1	2005.08	FAB.(J/V)
HYUNDAI E&C / SOUTH PARS 4 & 5	IRAN	FIRED HEATER	450 TON - 1	2003.05	FAB.(J/V)
HYUNDAI E&C, ITT / ATTAHADDY PROJECT	LIBYA	FIRED HEATER	ID 8,400 x 18,000L - 3	2001.06	FAB.





C. SRU EQUIPMENT (RECENT 10 YEARS)

CUSTOMER/PROJECT	SITE	ITEM NAME	SIZE - Q'TY	DEL.	Remark
PGSOC, NARDIS / BAGCR	IRAN	THERMAL INCINERATOR	ID 2,890 x 8,423L - 1	2016.06	w/WHB
IRPC, JOHN ZINK / SKEC UHV PROJECT	THAILAND	THERMAL REACTOR PKG & THERMAL INCINERATOR PKG	ID 2,300 x 7,000L - 9 ID 2,440 x 5,500L - 3	2015.04	w/WHB & ASME
POGC, PPI / SOUTH PARS P.19	IRAN	THERMAL REACTOR & THERMAL INCINERATOR	ID 3,300 x 15,000L - 4 ID 4,900 x 15,500L - 2	2014.11	w/WHB & CLAUSS
TSKE, SUMIYOSHI / RSAE PROJECT	RUSSIA	WASTE WATER INCINERATOR	ID 3,600 x 12,037 - 1	2014.01	
POGC, TECNIMONT / SPP 12	IRAN	THERMAL INCINERATOR	ID 4,200 x 17,000L - 4	2012.03	
LORC, IGC / LAVAN OIL REFINERY	IRAN	THERMAL REACTOR & INCINERATOR	ID 1,590 x 3,860L - 1 ID 1,600 x 5,500L - 1	2010.06	w/WHB
		SULPHUR CONDENSERS	ID 800 x 5,064L - 4	2010.05	
		CATALYTIC REACTORS	ID 1,800 x 4,800L - 2		
		HYDRAULIC SEALS	ø 8" x 7,075L - 3		
NIOEC, EHSAN JV / TEHRAN REFINERY UPGRADING	IRAN	THERMAL REACTOR & INCINERATOR PACKAGE	ID 2,280 x 6,700L - 1 ID 3,300 x 8,000L - 1	2010.04	w/WHB
		SULPHUR CONDENSERS	ID 1,750 x 6,100L - 2	2010.03	
SAZEH, HCE / ARAK REFINERY	IRAN	THERMAL INCINERATOR	ID 3,500 x 60,000L - 1	2009.06	
GS CALTEX / NO.4 DIESEL	S. KOREA	SRU INCINERATOR PKG.	OD 3,200 x 18,724L - 1	2008.04	
SHELL & OP, CHIYODA, HCE / PEARL - GTL PROJECT	QATAR	THERMAL INCINERATOR	ID 4,300 x 65,000L - 1	2008.04	
SKEC, HCE / SK NEW FCC	S. KOREA	AIR HEATER	ID 2,200 x 8,600L - 2	2007.07	
QAPCO, OP, ZEECO / QAPCO EP2 PROJECT	QATAR	THERMAL REACTOR & INCINERATOR PACKAGE	ID 2,400 x 7,020L - 1 OD 3,886 x 21,457L - 1	2007.01	ASME w/WHB
CHIYODA, ESSAR OIL REFINERY	INDIA	SRU INCINERATOR	1,130 TON - 1	2006.06	
SKEC, HCE / SK NEW FCC PROJECT	S. KOREA	AIR HEATER	30 TPH x 2 GCAL/HR - 1	2006.06	
JGC, HCE / SOHAR REFINERY PROJECT	OMAN	THERMAL REACTOR & INCINERATOR PACKAGE	ID 2,560 x 6,400L - 1 ID 2,500 x 7,800L - 1	2003.08	w/WHB
SFC / OPTIMIZATION PROJECT	S. KOREA	AIR HEATER	20 TPH x 1.3 GCAL/HR - 2	2003.04	





D. HEAT EXCHANGERS (RECENT 7 YEARS)

CUSTOMER/PROJECT	SITE	ITEM NAME	SIZE - Q'TY	DEL.	Remark
KPIC, NDEC/ 2 ND UREA & AMMONIA	IRAN	SHELL & TUBE HEAT EXCHANGER	ID 1,950 X 5,600L - 9	2016.08	
SABIC, INTECSA / SK WWT PROJECT	SAUDI ARABIA	BENZEN STRIPPER PACKAGE	ID 1,550 x 14,000L - 9	2015.07	
JG SUMMIT OLEFINS, JGC / C3/C4 STORAGE PROJECT	PHILIPPINES	SHELL & TUBE HEAT EXCHANGER	ID 650 X 4,000L - 2	2014.05	
SABIC, DHT/ SEP U&O - SWTU	SAUDI ARABIA	SHELL & TUBE HEAT EXCHANGER	ID 508 X 6,096L - 2	2014.01	ASME
AL HOSN GAS, CCC / SHAH GAS	U.A.E.	LIQUID SULPHUR COOLER	ID 1,050 X 9,753L - 6	2012.10	
TTCL / R PROJECT	THAILAND	SHELL & TUBE HEAT EXCHANGER	ID 1,670 X 5,850L - 44	2012.08	
POGC, OIEC / SP PHASE 20&21	IRAN	TITANIUM SHELL & TUBE HEAT EX	ID 780 x 5,486L - 10	2012.05	
PGSOC / BANDAR ABBAS GAS CRP	IRAN	TITANIUM SHELL & TUBE HEAT EX	ID 1,350 x 6,096L - 51	2011.12	
POGC, IGC / SOUTH PARS PHASE 1	IRAN	GAS & CONDENSATE COOLER (HASTELLOY)	ID 1,000 x 6,500L - 6	2011.11	Off-Shore
LORC, IGC / LAVAN OIL REFINERY	IRAN	LPG VAPORIZER PKG	ID 544 x 1,500L - 1	2011.11	
		FINAL CONDENSER	ID 800 x 5,000L - 4	2010.06	
		STRON CAUSTIC CIRCULATION COOLER	ø 3" x 5,500L - 1 (1 PARALLEL 12 SERIES)	2010.06	
POGC, IGC / SOUTH PARS PHASE 1	IRAN	G&C COOLER (INCONEL)	ID985 x 5,950L - 6	2010.06	Off-Shore
NIOEC / TEHRAN REFINERY	IRAN	SPECIAL EXCHANGER	ID1,750 x 6,100L - 3	2010.01	
IGC / LAVAN OIL REFINERY	IRAN	DIH SIDE REBOILER	ID1,600 x 6,000L - 57	2009.12	
SAUDI KAYAN / HDPE	SAUDI ARABIA	EVAPORATOR	ID2,500 x 3,658L - 31	2009.04	ASME
SAUDI KAYAN / PP(AL-JUBAIL)	SAUDI ARABIA	STEAM CONDENSATE	ID550 x 3,051L - 1	2008.05	ASME
GS CALTEX / NO.4 DIESEL HSD	S. KOREA	HYDROGEN AFTER COOLER	ID600 x 3,080L - 3	2008.02	
SAMSUNG TOTAL, TOYO / OL EFINS CONVERSION	S. KOREA	DEISOBUTENIZER	ID720 x 6,000L - 1	2008.01	
SAMSUNG TOTAL / EO-EG	S. KOREA	2 ND & 4 TH STAGE COOLER	ID3,071 x 4,000L - 11	2007.09	
		TH	ID1,080 x 3,781L - 2 (UOP 90/10 LOW FINNED)	2007.04	
		5 TH EFFECT REBOILER	ID1,325 x 3,000L - 1 (UOP HIGH FLUX)	2007.04	





E. PRESSURE VESSELS (RECENT 7 YEARS)

CUSTOMER/PROJECT	SITE	ITEM NAME	SIZE/Q'TY	DEL.	REMARK
AFW, DAELIM / S-OIL ENERGY RECOVERY PKG	ONSAN, S. KOREA	LP & HP STEAM DRUM	ID 2,200 x 10,000 - 2	2016.11	
RELIANCE / J3-LLDPE PROJECT	INDIA	CS PRESSURE VESSEL	ID 6,000 x 18,000L - 16	2014.11	
SABIC, DHT / SEP U&O - DEMIN	SAUDI ARABIA	DEMINERALIZED WATER PKG	ID 4,100 x 4,550L - 4	2014.03	
SABIC, DHT / SEP U&O - SWTU	SAUDI ARABIA	ATMOSPHERIC STORAGE TANK	ID 4,000 x 5,800L - 2	2014.01	ASME
SK INNOVATION, SKEC / NEW PX PROJECT	S. KOREA	PRESSURE VESSEL III	ID 1,700 x 4,200H - 5	2013.05	ASME
ARAMCO, HYOSUNG / JUBAIL EXPORT REFINERY	SAUDI ARABIA	PRIMING TANK	ID 2,000 x 1,800L - 10	2011.12	ASME
FERTIL, JOHN ZINK / FERTIL-2	U.A.E.	GRANULATOR & COOLER SCRUBBER	W 5,00 x H 14,600 x 5,000L	2011.05	
HHI, DAHLMAN / SHWE FIELD	MYANMMAR	CATRIDGE & BASKET FILTER	ID 1,371 x 3,504L	2011.04	Off-Shore
LORC, IGC / LAVAN OIL REFINERY	IRAN	RECEIVER w/ BASKET FILTER	ID 2,400 x 5,000L	2011.01	
AIR PRODUCTS, DAHLMAN / TECHNIP HYCO4	NETHERLANDS	GAS & COALESCER FILTER	ID 1,168 x 3,500L	2010.06	ASME & CE
LORC, IGC / LAVAN OIL REFINERY	IRAN	CATALYSTIC & REDUCING REACTOR	ID1,800 x 4,800L - 2	2010.05	
SAUDI KAYAN / HDPE	SAUDI ARABIA	BUTENE-1 STORAGE	ID3,300 x 14,000L - 35	2009.05	
GS CALTEX / NO.3 HOU	S. KOREA	SOUR WATER SURGE	ID3,048 x 7,600L - 35	2009.04	
SAUDI KAYAN, SECL / AMINE	SAUDI ARABIA	DMF SHIFT TANK	ID4,300 x 12,900L - 31	2009.03	ASME
		TMA SURGE VESSEL	ID3,700 x 11,100L - 23	2009.03	
		MA RECYCLE TANK	ID3,200 x 10,000L - 28	2009.03	ASME
SAUDI KAYAN, SECL / PP & PH	SAUDI ARABIA	JACKET WATER SURGE	ID1,400 x 2,000 - 36	2008.05	ASME
SAMSUNG ENG / MOC CRACKER	THAILAND	DEMETANIZER FEED	ID1,950 x 44,100L - 9	2008.02	ASME
SAMSUNG TOTAL / TOYO (OCU)	S. KOREA	DEBUTANIZER REF.DRUM	ID3,800 x 9,800L - 23	2008.01	
SAMSUNG ENG / IBN ZAHR	SAUDI ARABIA	FRESH/RECYCLE C4	ID2,800 x 13,350L - 13	2007.01	
SAMSUNG ENG / TASNEE	SAUDI ARABIA	COKE COLLECTING TANK	W1,200 x 2,850H x 3,800L - 3	2007.05	
ONGC, AXIA HOWMAR / VASAI	INDIA	IGF VESSEL	ID1,500 x 6,800L - 12	2007.06	ASME
SWEC, DHT / SHUAIBAH IWPP	SAUDI ARABIA	CAUSTIC SODA TANK	ID3,575 x 5,200L - 3	2007.05	
ONGC, SAMSUNG HEAVY / VASAI	INDIA	DEOXYGENATION TOWER	ID 2,000 x 17,500L (LINED)	2007.05	ASME & PED
SAMSUNG TOTAL / P2	S. KOREA	ETHYLENE DRYING	ID1,400 x 3,800L - 6	2007.04	
SABIC, SAMSUNG ENG / IBN ZAHR	SAUDI ARIBIA	FRESH/RECYCLE C4	ID 2,800 x 13,350L	2007.01	ASME





F. STEEL STRUCTURE (RECENT 10 YEARS)

CUSTOMER/PROJECT	SITE	ITEM NAME	WEIGHT (TON)	DEL.
RELIANCE / J-3 EXPANSION	INDIA	STEEL STRUCTURE FOR JAMNAGAR 3 REFINERY	12,000	2015.08
SAMSUNG / SMP	S. KOREA	STEEL STRUCTURE FOR W-1 CHEMICAL PLANT	2,197	2013.05
ITAS / DMC 4&5	IRAN	STEEL STRUCTURE FOR ELIVATED FLARE STACK	88.71	2013.01
SAMSUNG / MA'ADEN	SAUDI ARABIA	STEEL STRUCTURE FOR ALUMINIUM ROLLING MILL	1,834	2012.12
SAMSUNG / FERTIL	UAE	STEEL STRUCTURE FOR AMMONIA PLANT	3,278	2012.07
TAKREER, GS E&C / RRE-2	UAE	STEEL STRUCTURE FOR REFINERY EXPANSION	8,380	2012.05
OPWP, GS E&C / SOHAR 2 IPP	OMAN	STEEL STRUCTURE	3,759	2011.01
OPWP, GS E&C / BARKA 3 IPP	OMAN	STEEL STRUCTURE	3,560	2011.01
PETROBRAS, HCE/ODEBEI	BRAZIL	STEEL WORKS FOR OPEN GROUND FLARE	119	2009.05
HYUNDAI STEEL/SINTER PLANT	S. KOREA	STEEL STRUCTURE	1,480	2009.02
ZEECO / QATAR BERTH#6	QATAR	STEEL WORKS FOR FLARE (SELF-SUPPORTED)	63	2008.05
SAMSUNG / MOC CRACKER	THAILAND	STEEL STRUCTURE MOC CRACKER	2,170	2008.10
GS CALTEX, HYI / NO.4 DIESEL	S. KOREA	STEEL WORKS FOR INCINERATOR	77	2008.04
CHIYODA, HAMWORTY / GTL	QATAR	STEEL WORKS FOR INCINERATOR	102	2008.04
GS E&C / SALALAH METHANOL	OMAN	STEEL STRUCTURE FOR SMC	7,933	2008.04
ABB-SHELL, HCE / ECC	SINGAPORE	STEEL WORKS OF RISER	90	2007.11
SAMSUNG / NHT & CCR	TOBAGO	STEEL STRUCTURE FOR PETROTRIN	1,238	2007.07
LOTTE LPC / SEG	S. KOREA	STEEL STRUCTURE FOR LPC-SEG	2,010	2007.05
SAMSUNG TOTAL / PP	S. KOREA	STEEL STRUCTURE FOR PP	2,087	2007.02
CHIYODA, ZEECO / QCS	QATAR	STACK & STEEL STRUCTURE	683	2006.11
CHIYODA / ESSAR OIL REFINERY	INDIA	STEEL STRUCTURE, INCINERATOR & DUCT	1,460	2006.07
GS E&C / LG BOHAI VCM	CHINA	VCM/EDC STEEL STRUCTURE	1,870	2006.12
DOOSAN HEAVY / ZAWIA CCPP	LIBYA	STEEL STRUCTURE FOR HRSG	2,700	2005.12
ALSTOM / ENFIELD	AUSTRALIA	CASING & DUCT	230	2005.03
EXXON MOBIL, CHIYODA / AKG	QATAR	LNG, DERRICK STEEL STRUCTURE & FLARE STACK	1,270	2005.02



6. Major Clients List



HANIL

- 1
- 2
- 3
- 4
- 5
- 6
- 7
- 8
- 9
- 10
- 11
- 12
- 13
- 14
- 15
- 16
- 17
- 18
- 19
- 20
- 21
- 22
- 23
- 24
- 25
- 26
- 27
- 28
- 29





- *1. Company Profile*
- *2. Product Group*
- *3. Company Organization*
- *4. Manufacturing Facilities*
- *5. Recent Reference Photos*
- *6. Major Reference & Clients List*
- *7. Certificates*
- *8. Progress Management Program*

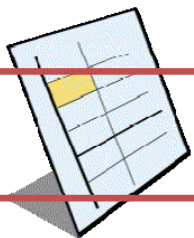

CERTIFICATE OF ISO 9001:2008



Certificate of Quality Management System

HANIL HEAVY INDUSTRIES Co., Ltd.
Issue No : QC-0266-E(0)

KGS certifies that The Quality Management System of the above organization has been assessed and found to be in accordance with the requirements of the standard and scope of certification detailed below

Standard : KS Q ISO 9001:2009 / ISO 9001:2008

Scope : Design, Production, Installation and Additional services of Pressure Vessel, Heat Exchanger, Boiler Package, Fired Heater, Incinerator, Sulfur Recovery Unit Structure

Valid period : 2014. 8. 23. ~ 2017. 8. 22.

Site of certificate
Head Office : 33, Sinhang 7-ro, Jinhae-gu, Changwon-si, Gyeongsangnam-do, KOREA
2nd Factory : 130, Noksansaneopjung-ro, Gangseo-gu, Busan, KOREA

Aug. 4, 2014



Korea Gas Safety Corporation
1390, Wonjung-ro, Maengdong-myeon, Eumseong-gun, Chungcheongbuk-do, KOREA

The KAB mark is an accreditation mark to indicate that an organization has been designated by Korea Accreditation Board as a QMS(Quality Management System) certification body.(Licence No.:KAB-QC-22)



Daechun Jun

CERTIFICATE OF ISO 14001:2004



Certificate of Environmental Management System

HANIL HEAVY INDUSTRIES Co., Ltd.
Issue No : EC-0159-A(1)

KGS certifies that The Environmental Management System of the above organization has been assessed and found to be in accordance with the requirements of the standard and scope of certification detailed below

Standard : KS I ISO 14001:2009 / ISO 14001:2004

Scope : Environmental Management System for Pressure Vessel, Heat Exchanger, Boiler Package, Fired Heater, Incinerator, Sulfur Recovery Unit Structure

Valid period : 2013. 12. 30. ~ 2016. 12. 29.

Site of certificate
Head Office : 33, Sinhang 7-ro, Jinhae-gu, Changwon-si, Gyeongsangnam-do, KOREA
2nd Factory : 130, Noksansaneopjung-ro, Gangseo-gu, Busan, KOREA

Aug. 4, 2014



Korea Gas Safety Corporation
1390, Wonjung-ro, Maengdong-myeon, Eumseong-gun, Chungcheongbuk-do, KOREA

The KAB mark is an accreditation mark to indicate that an organization has been designated by Korea Accreditation Board as a EMS(Environmental Management System) certification body.(Licence No.:KAB-EC-15)



Daechun Jun

ASME STAMP - U

ASME STAMP - S

ASME NATIONAL BOARD



CERTIFICATE OF AUTHORIZATION

The named company is authorized by the American Society of Mechanical Engineers (ASME) for the scope of activity shown below in accordance with the applicable rules of the ASME Boiler and Pressure Vessel Code. The use of the certification mark and the authority granted by this Certificate of Authorization are subject to the provisions of the agreement set forth in the application. Any construction stamped with this certification mark shall have been built strictly in accordance with the provisions of the ASME Boiler and Pressure Vessel Code.

COMPANY:
Hanil Heavy Industries Co.,Ltd.(HANIL)
33, Sinhang 7-ro, Jinhae-gu, Changwon-si
Gyeongsangnam-do 645-370
Republic of Korea

SCOPE:
Manufacture of pressure vessels at the above location and field sites controlled by the above location (This authorization does not cover impregnated graphite)

AUTHORIZED: February 9, 2015
EXPIRES: February 9, 2018
CERTIFICATE NUMBER: 48,611

Byoung A. Suh
Vice President, Conformity Assessment

Joseph J. Lancaster
Director, Conformity Assessment





CERTIFICATE OF AUTHORIZATION

The named company is authorized by the American Society of Mechanical Engineers (ASME) for the scope of activity shown below in accordance with the applicable rules of the ASME Boiler and Pressure Vessel Code. The use of the certification mark and the authority granted by this Certificate of Authorization are subject to the provisions of the agreement set forth in the application. Any construction stamped with this certification mark shall have been built strictly in accordance with the provisions of the ASME Boiler and Pressure Vessel Code.

COMPANY:
Hanil Heavy Industries Co.,Ltd.(HANIL)
33, Sinhang 7-ro, Jinhae-gu, Changwon-si
Gyeongsangnam-do 645-370
Republic of Korea

SCOPE:
Manufacture and assembly of power boilers at the above location and field sites controlled by the above location

AUTHORIZED: February 9, 2015
EXPIRES: February 9, 2018
CERTIFICATE NUMBER: 48,610

Byoung A. Suh
Vice President, Conformity Assessment

Joseph J. Lancaster
Director, Conformity Assessment



THE NATIONAL BOARD OF BOILER & PRESSURE VESSEL INSPECTORS

*Certificate of Authorization
to Register*



This is to certify that

Hanil Heavy Industries Co., Ltd.(HANIL)
33, Sinhang 7-ro, Jinhae-gu, Changwon-si
Gyeongsangnam-do 645-370
Republic of Korea

*is authorized to apply the "NB" mark and register
boilers, pressure vessels or other pressure retaining
items with the National Board.*

*The scope of Authorization is limited to items
manufactured in accordance with:*

ASME Designator(s): U, S

ISSUE DATE: February 9, 2015

*This Certificate of Authorization to Register will remain
in effect as long as the manufacturing organization holds
a valid Certificate of Authorization issued by the
American Society of Mechanical Engineers.*

Executive Director *[Signature]*



NB 127 Rev. 9



ARAMCO

NIOEC

Aramco Overseas Company B.V. Tel: 81(3) 5463-8102
 Aramco Bldg, P.O. Box 129 Fax: 81(3) 5463-8144
 No. 12-31, Akasaka 1-chome,
 Minato-ku, Tokyo 107-6010, Japan

Hanil Heavy Industries Co., Ltd
ATTN: MR. S.W.KIM, Marketing Director
401, BEAKAK BLDG., 828-53, YEOKSAM-DONG
SEOUL 135-935
SOUTH KOREA

September 5, 2007

Dear Sir,

Re: Company Registration

We herewith confirm that you are registered with Aramco Overseas Company BV and your Vendor ID is **10037132**.

Following material is linked to your ID:

9COM	DESCRIPTION
6000000611	ANGLE; STRUCTURAL; STEEL; 12-SAMSS-007;
6000000620	CHANNEL; STRUCTURAL; STRUCTURAL SHAPE; C
6000000624	CONE; STRUCTURAL; CARBON STEEL;
6000000689	FRAME
6000000693	BEAM; STRUCTURAL; STRUCTURAL SHAPES; ANG

This registration letter should not be construed as a commitment by AOC to purchase from you. However, your company will have the opportunity along with other approved suppliers to respond to requests for submitting proposals in accordance with AOC's established policies and procedures.

AOC would like to take this opportunity and thank you for your interest in doing business with AOC/Saudi Aramco. Please use the above referenced Vendor ID on all future written correspondence.

Should you require any further information, please do not hesitate to contact our office.

Very truly yours,

 Yukichi Goto
 Representative (AA)
 Aramco Overseas Company B.V. Tokyo

It is the responsibility of the manufacturer to notify AOC-Tokyo Supplier Relations Group of the following:

1. Change of Name/Address
2. Any change of manufacturing location (sub sourcing fabrication of major components)
3. Discontinuance of fabrication of approved 9COMs

AAI-TND
 ۷۷۱۵-۱-۱-۱۱۷۷۷
 شرکت ملی صنایع پتروشیمی ایران
 گروه شرکت های تخصصی و خدماتی پتروشیمی

بسمه تعالی

مدیر عامل محترم شرکت پترو سامان

با سلام ،

محترماً تحلف به درخواست شماره PS/88-169 مورخ ۸۸/۷/۱۵ به اطلاع می‌رساند بر اساس تصویب و دومین جلسه مورخ ۸۸/۷/۱۴ کمیته تعیین صلاحیت سازندگان / فروشندگان، نام شرکت Hanil Heavy Industry Co.Ltd (گروه جنوبی) در لیست سازندگان / فروشندگان (Vendor List) شرکت ملی مهندسی و ساختمان نفت ایران برای مدت دو سال از تاریخ جلسه فوق به عنوان تولیدکننده محصولات نامبرده ذیل به ثبت رسیده است. تمهید اعتبار منوط به تأیید مجدد بر اساس عملکرد آن شرکت خواهد بود. مشافاً اینکه فراگرفتن نام آن شرکت در لیست سازندگان / فروشندگان این شرکت لزوماً هیچگونه تعهدی جهت خرید ایجاد نمی‌نماید. مشافاً نام شرکت پتروسامان به عنوان نماینده شرکت لوی به ثبت رسیده است.

- 1- Fired Heater
- 2- Utilities Boiler
- 3- Heat Exchanger (Shell & Tube)
- 4- Incinerator

 امیرحسین موسی زاده
 رئیس خدمات فنی و بررسی منابع کالاها

گروه شرکت های تخصصی و خدماتی پتروشیمی
 صندوق پستی ۱۱۳۶۵۱۶۷۱۷ تهران ۱۱۳۶۱
 WWW.sioec.org





SAMSUNG ENGINEERING GOLD MEMBER

SK ENERGY APPRECIATION LETTER





- *1. Company Profile*
- *2. Product Group*
- *3. Company Organization*
- *4. Manufacturing Facilities*
- *5. Recent Reference Photos*
- *6. Major Reference & Clients List*
- *7. Certificates*
- *8. Progress Management Program*

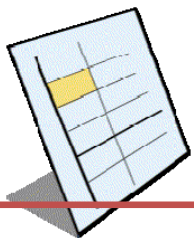



Progress Manager Menu

PROGRESS MANAGER
for Fabrication of Steel Structure
V9.06

HANIL Heavy Ind.

Cover Sheet | Enter Project Data

Summary of Progress Status | BOM | Suborder Status | Fabrication

Progress Check | Progress Data | Delivery Status | VPIS | Highlight Photo

Program Information

Project Name	Salalah Methanol Project	Contracted Weight	4,700.00 ton
Project No.	7S72	Revised Weight	7,800.00 ton
Item Name	Steel Structure	Customer	Salalah Methanol Company
Item No.	7S70	Contractor	GS E&C
P.O. No.	4500001332-3	Supplier	Hanil Heavy Industries Co., Ltd.
Contracted Date	12-Oct-2007	Site	Salalah, Oman
Contracted Delivery Date	31-Dec-2007 ~ 31-Dec-2008	Delivery Condition	FOB Busan Port
Revised Delivery Date	31-Dec-2007 ~ 30-Mar-2009	Work Scope	Included Shop DWG & Material
Contracted description	Supply of Shop Drawing & Fabrication		

955, Sinban-ri, Burim-Myeon, Uiryong-gun, Gyeongsangnam-do, 636-803 S.Korea. Tel.+82-55-572-1715 / Hanil Heavy Industries Co., Ltd. / dm.kim@hanilhi.com

1. Project Data
2. Progress Status
3. BOM Summary
4. Suborder Status for Materials
5. Fabrication & Delivery Schedule
6. Progress Check List

7. Photos of actual Progress Work
8. Vendor Print Index & Schedule
9. Delivery Status
10. Invoicing Status
11. Supply List
12. Drawing List & Status
13. Packing List



Weekly Progress Report

[Print Out / Report](#) [Enter Project Data](#) [To Cover Sheet](#)

HANIL Heavy Ind.

WEEKLY PROGRESS REPORT

[Progress Status](#) [Fabrication Schedule](#) [Delivery Status](#) [BOM](#) [Invoicing Status](#)
[Suborder Status](#) [Progress Check List](#) [Highlight Photo](#) [VPIS](#) [Report Mail](#) <http://www.mail@hanmail.net>

To : GS E&C / SMC Project Team
 Attn : PPM / Mr.
 From : Hanil Heavy Ind. Co., Ltd. / PM D.M. Kim
 Sub : Project Name : Salalah Methanol Project Project No. : 7S72
 Item Name : Steel Structure Item No. : 7S70
 Purchase Order No : 4500001332-3 Job No. : 7S70
 Purchase Order Description : Supply of Shop Drawing & Fabrication

STATUS OF THE SUBJECT ORDER AS OF 30-Mar-2008

1. DELIVERY DATE

Current delivery related to contractual date

Maintained Improved Slipped Revised

Contractual delivery date / place : 31-Dec-08 / FOB Busan Port

Revised delivery date / place : 30-Mar-09 /

Current estimated delivery date : 30-Mar-09 /

Number of days remaining to delivery date : 276 days Working days until present : 136 days of 501 days

Reason for delivery Slippage / Revision :

2. PROGRESS STATUS

Seq. of Del.	Item No.	Weight (ton)		Increase or Decrease	Shop DWG		Material		Paint Finish		Final Insp.		Delivery		Expected Del. Date
		Contract	DWG		Ton	%	Ton	%	Ton	%	Ton	%	Ton	%	
1	Pipe Rack 1	26.0	26.0	- 0.0	26.0	100	26.0	100	26.0	100	26.0	100	26.0	100	30-Dec-07
2	Pipe Rack 2	51.5	51.5	0.0	80.0	155	51.5	100	51.5	100	51.5	100	51.5	100	30-Dec-07
3	Pipe Rack 3	42.9	42.9	0.0	-	-	42.9	100	41.4	97	41.4	97	41.4	97	30-Jan-08
4	Pipe Rack 4	59.4	59.4	0.0	-	-	59.4	100	54.4	92	53.7	90	53.7	90	30-Jan-08
5	Pipe Rack 5	39.5	39.5	0.0	-	-	39.5	100	36.7	93	36.7	93	36.7	93	28-Feb-08
6	Equipment 1	7.3	7.3	0.0	-	-	7.3	100	3.0	42	3.0	42	-	-	30-Mar-08
7	Equipment 2	68.4	68.4	0.0	-	-	68.4	100	35.5	52	35.5	52	35.5	52	30-Apr-08
8	Equipment 3	256.3	256.3	0.0	-	-	256.3	100	95.2	37	94.4	37	73.1	29	30-May-08
9	Equipment 4	25.3	25.3	0.0	-	-	25.3	100	24.5	97	24.5	97	21.4	85	30-Jun-08
10	Equipment 5	4.1	4.1	0.0	-	-	4.1	100	3.9	95	3.9	95	3.2	79	30-Jul-08
11	Equipment 6	64.7	64.7	0.0	-	-	64.7	100	16.8	26	-	-	-	-	30-Aug-08
12	Equipment 7	12.5	12.5	- 0.0	-	-	12.5	100	12.5	100	12.5	100	10.1	81	30-Sep-08
13	Equipment 8	23.7	23.7	- 0.0	-	-	23.7	100	22.7	96	22.7	96	16.9	71	30-Oct-08
14	Equipment 9	1,000.0	-	- 1,000.0	-	-	-	-	-	-	0.0	-	0.0	-	30-Nov-08
15	Equipment 10	1,000.0	-	- 1,000.0	-	-	-	-	-	-	94.4	-	73.1	-	31-Dec-08
16	0														
17	0														
18	0														
19	0														
20	0														
TOTAL		2,681.6	681.6	- 2,000.0	106.0	16	681.6	100	424.2	62	600.2	73	442.6	65	

Current Progress Rate : **88.9%** of **681.6** tons

8. Progress Management Program

Progress Check List by Weight (Target vs. Actual)

[To Cover Sheet](#) | [Print Out / Report](#) | [Enter Project Data](#) | [Progress Report](#) | [Progress Status](#) | [BOM](#) | [Sub Order Status](#) | [Fabrication Schedule](#) | [Highlight Photo](#) | [Delivery Status](#) | [VPI5](#) | [Invoicing Status](#)

HANIL Heavy Ind. | Project Name : Salah Methanol Project | Project No. : 7872 | PO No. : 450001332-3 | Checked by : / Hanil Heavy Industries Co., Lt

No.	Item No.	Part No.	Part Name	Rev. No.	Description	Qty (pcs)	Length	Area (㎡)	EL	Total Wt (kg)	PROCESS											Del. Date
											Mat'l	Cut & Drill Beam	Cut & Drill Plates	Fit-up	Weld	Inspection	SSPC/1st Coat	2nd & Final Coat	Packing	Final Inspection	Delivery	
											15%	95%	10%	20%	15%	8%	90%	3%	7%	1%	1%	100%

SEARCH - ITEM					Item No	Qty (pcs)	Area (㎡)	Total Weight (kg)	소재	절단	소부재	허브	용접	중간검사	소트하도	중상도	포장	최종검사	납품	Req'd Del.	
Pipe Rack 1					PR1234	275	0	26,043	100.0%	100.0%	100.0%	100.0%	100.0%	100.0%	100.0%	100.0%	100.0%	100.0%	100.0%	100.0%	19-Apr-11



Progress Status by Weight

SN	Item Name	Item No.	Qty (pcs)	Weight (kg)	Mat'l	Cut & Drill Shape Steel	Cut & Drill Plates	Fit-up	Weld	Inspection	SSPC/1st Coat	2nd & Final Coat	Packing	Final Inspection	Delivery	Target Del. Pgr. Rate
1	Pipe Rack 1	PR1234	275	26,043	100.0%	100.0%	100.0%	100.0%	100.0%	100.0%	100.0%	100.0%	100.0%	100.0%	100.0%	100.0%
2	Pipe Rack 2	SD47R1-2	427	51,485	100.0%	100.0%	100.0%	100.0%	100.0%	100.0%	100.0%	100.0%	100.0%	100.0%	100.0%	100.0%

Target Progress Rate	Start Date (Target)	Finish Date (Target)	Total Working Day	Settle Factor	Date	Mat'l	Cut & Drill Shape Steel	Cut & Drill Plates	Fit-up	Weld	Inspection	SSPC/1st Coat	2nd & Final Coat	Packing	Final Inspection	Delivery	Total
	05-Nov-07	30-Mar-09	511 days	- days	30-Jan-2009	89.5%	87.5%	86.5%	85.5%	84.5%	83.4%	82.4%	81.6%	80.6%	79.4%	78.7%	85.1%

Progress Balance Rate for Target vs Actual	Date	Mat'l	Cut & Drill Shape Steel	Cut & Drill Plates	Fit-up	Weld	Inspection	SSPC/1st Coat	2nd & Final Coat	Packing	Final Inspection	Delivery	Total
	30-Jan-2009	14.4%	11.4%	12.4%	13.2%	8.6%	-6.7%	-11.2%	-29.5%	-18.5%	-21.2%	-25.4%	3.8%

Shortened or Delayed Schedule: 26.0 ton, 44.4 M/D, 1.8 mdton

Progress Status by Weight 30-Jan-2009



8. Progress Management Program



HANIL

Progress Check List by Pieces (Target vs. Actual)

HANIL Heavy Ind.		PROJECT NAME : Sabalah Methanol Project										PROJECT NO. : 7872		PO NO. : 450001332-3		Checked by : _____ / Hanil Heavy Industries Co., Ltd.						
Progress Status by Pieces				Progress Display (XXX) : 중량부족 (XXX) : 중량초과										Checked Date : 30, Jan. 2009								
No.	Item Name & No.	Rev. No.	Description	QTY (pcs)	Length (mm)	Area (㎡)	EL.	Total Wt (kg)	Matl	Cut & Drill Beam	Cut & Drill Plates	Fit-up	Weld	Insp.	SSPC1st Coat	2nd & Final Coat	Packing	Final Inspection	Delivery	Remarks		
SEARCH - ITEM																						
	Column			1				146	1	1	1	1	1	1	1	1	1	1	1	1		
	Girder			7				1,885	7	7	7	7	7	7	7	7	7	7	7	7		
	Beam			118				15,060	118	118	118	118	118	118	118	118	118	118	118	118		
	BR/A			148				8,302	148	148	148	148	148	148	148	148	148	148	148	148		
	PR1234																					
	Miscellaneous			-				-	-	-	-	-	-	-	-	-	-	-	-	-		
	Total			275				26,043	275	275	275	275	275	275	275	275	275	275	275	275		
No.	Item No.	Part No.	Part Name	Rev. No.	Description	QTY (pcs)	Length	Area (㎡)	EL.	Total Wt (kg)	PROCESS										Del. Date	
											Matl	Cut & Drill Beam	Cut & Drill Plates	Fit-up	Weld	Inspection	SSPC1st Coat	2nd & Final Coat	Packing	Final Inspection	Delivery	Progress Rate
											10%	8%	10%	25%	10%	5%	10%	2%	7%	1%	1%	100%
3		Pipe Rack 3	SD42R3-		Column	92				4,922	92	92	92	92	92	92	92	92	92	92	92	92
					Girder	7				1,585	7	7	7	7	7	7	7	7	7	7	7	7
					Beam	113				23,554	113	113	113	113	113	113	113	113	113	113	113	113
					Brace & Loose P.	130				9,198	130	130	130	130	130	130	130	130	130	130	130	130
					Miscellaneous	4				4,673	4	4	4	4	4	4	4	4	4	4	4	4
					S.Total Pipe Rack 3 / SD42R3-	346				42,933	346	346	346	346	346	346	346	346	346	346	346	346
2		Pipe Rack 2	TOTAL SU-HK1-2		Column	1,447				303,780	1,447	1,447	1,447	1,447	1,354	1,126	929	683	683	542	419	
					Girder	245				115,885	245	245	245	245	244	218	208	177	177	175	163	
					Beam	1,514				490,426	1,514	1,514	1,514	1,497	1,414	1,182	1,126	1,059	1,059	1,055	1,084	
					Brace & Loose P.	2,097				81,931	2,097	2,097	2,097	2,072	1,941	1,111	1,088	997	997	997	984	
					Miscellaneous	16				240,778	16	16	16	16	16	16	16	16	16	16	16	
					S.Total Pipe Rack 2 / SU-HK1-2	5,319				1,194,497	5,319	5,319	5,319	5,277	4,969	3,654	3,339	2,952	2,952	2,883	2,641	
					TOTAL	5,319				1,194,497	5,319	5,319	5,319	5,277	4,969	3,654	3,339	2,952	2,952	2,883	2,641	
Part Search	Part No.		Rev	Material	Qty	Length	Area	EL.	Weight (kg)	자재	공인	소량부	특부	합금	열간연사	스트리트도	열상도	모양	외형검사	납품	Del. Date	
	PR1234C2			Column 8 H294*200*8*12	1			15000	135.98	1	1	1	1	1	1	1	1	1	1	1	1	28-Dec-07
Progress Check for Each Part																						
S/N	Item No.	Part No.	Part Name	Rev No	Material	QTY (pcs)	Length (mm)	Area (㎡)	EL.	Weight (kg)	자재	공인	소량부	특부	합금	열간연사	스트리트도	열상도	모양	외형검사	납품	Del. Date
0001	PR1234C1/C1	Column	8	H294*200*8*12	1			15000	135.98	1	1	1	1	1	1	1	1	1	1	1	1	28-Dec-07
0002	PR1234C2/C2	Column	8	H294*200*8*12	1			15000	135.98	1	1	1	1	1	1	1	1	1	1	1	1	28-Dec-07
0003	PR1234C3/C3	Column	8	H294*200*8*12	1			15000	135.98	1	1	1	1	1	1	1	1	1	1	1	1	28-Dec-07





THANK YOU